

1984-1987 BMW 325E 2.7L

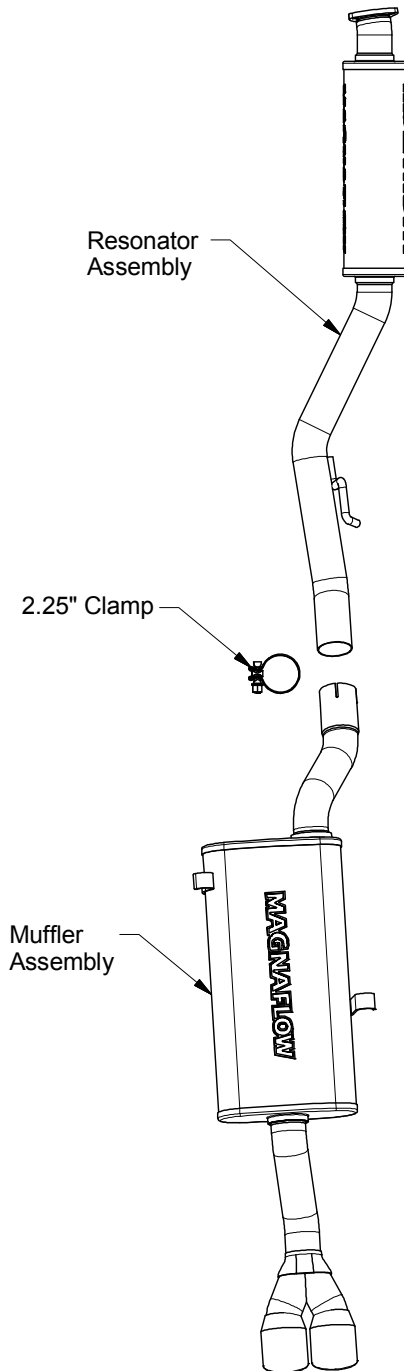

Warning: When working on, under, or around any vehicle exercise caution. Please allow the vehicle's exhaust system to cool before removal, as exhaust system temperatures may cause severe burns. If working without a lift, always consult vehicle manual for correct lifting specifications. Always wear safety glasses and ensure a safe work area. Serious injury or death could occur if safety measures are not followed.

Step 1: (Carefully read all instructions before installation). To remove your OEM exhaust system, begin by unbolting the exhaust inlet flange from the catalytic converter and remove the hangers from the rubber insulators making sure to retain all hardware as it will be needed to install your new MAGNAFLOW performance exhaust system.

Step 2: Install your new exhaust system by fastening the Resonator Assembly to the catalytic converter and locate the hanger to the rubber insulator. Next, slip the inlet of the Muffler Assembly over the outlet of the Resonator Assembly and use the supplied clamp to secure. Use OEM hardware to secure the Muffler Assembly.

Step 3: With all components mounted loosely, adjust the system for overall aesthetics and clearance of frame & bodywork. (MAGNAFLOW recommends at least 1/2" of clearance between the exhaust system and any body panels to prevent heat-related body damage or fire.)

Step 4: Once a final position has been chosen for the new system, evenly tighten all fasteners from front to rear. The supplied band clamps must be VERY tight to properly align the pipes and prevent leaks (Approximately 40ft-lbs). Inspect all fasteners after 25-50 miles of operation and retighten if necessary.

**** Magnaflow Performance Exhaust recommends professional installation on all their products**